

Product datasheet

Article no.: 740005

Underwater lamp, Fiara, silver, 24V DC, 10,00 W, warmwhite

Technical Data

General Characteristics

Material	stainless steel
Colour	silver
Optics	
included in delivery	10,0m connection cable with WEIPU connector IP67 1x hexagon socket wrench



Electrical Characteristics

Power / power consumption	10,00 W / 10,00 W
Input voltage	24V DC
Input current	
Base (standard designation)	
Number of bases	
Power supply unit	excl. LED-power supply unit
Connection possibility	Weipu Male
Protection class I, II, III	III

Light Technical Data

Bulb	LED-module fixed
Colour Designation	warmwhite
Colour temperature	3000 K
Luminous flux	670 lm
Beam angle	25°
LED type	COB
LED quantity	1
Spectral power distribution	583 nm

Product datasheet

Article no.: 740005

Underwater lamp, Fiara, silver, 24V DC, 10,00 W, warmwhite

Light Direction

Rotating and tilting range	rotatable-swivel
Angle of inclination	180°
Radiation direction	
Reflector / lense	symmetrisch

Dimensions & Weight

Length	95 mm
Width	106 mm
Height	150 mm
Diameter	95 mm
Mounting Depth	
Product Weight	1959 g

Cut-out dimensions

Length	
Width	
Diameter	

Mounting Bowl

Material	
Length	
Width	
Height	
Diameter	

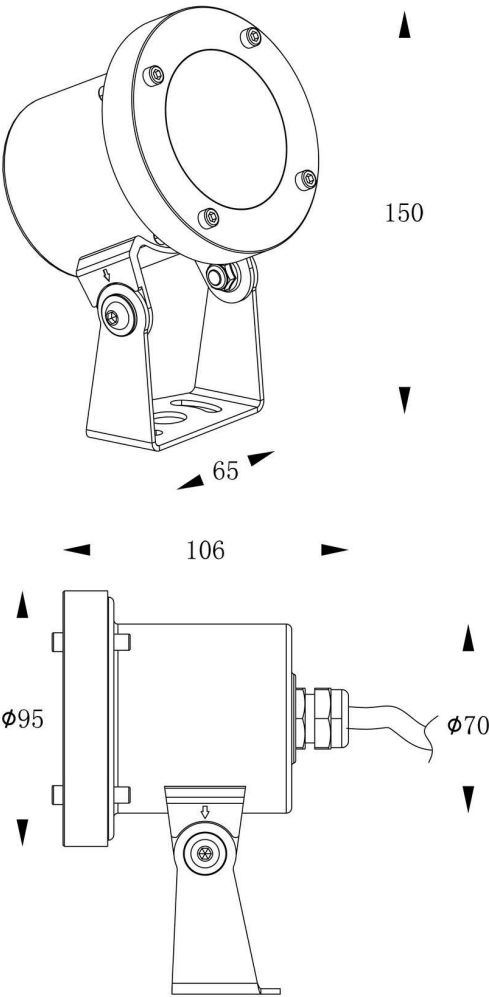

Product datasheet

Article no.: 740005

Underwater lamp, Fiara, silver, 24V DC, 10,00 W, warmwhite

Absolute maximum ratings

The LED will get damaged and the lifetime will decrease when you overrun absolute maximum ratings.

Working temperature	-20°C - +50°C
Storage temperature	-20°C - +60°C
IP - Code	IP68/max.2m

General product data

Environmental Characteristics

Energy label	A
Energy consumption	10 kWh/1000h

Lifespan

Lamp life time	25000 h
Luminous flux (end of lifetime)	0,70
Number of switching cycles	100000

IP68/max.2m Protection against penetration of dust. (complete dust protection) Protection against permanently immersion (max. 2m). IP rating refers only to the light.



Lightings of Protection Class III
Luminaire in which protection against electric shock relies on supply at safety extra-low voltage (SELV) and in which voltages higher than those of SELV are not generated.



Because of the complex manufacturing process of the LED the above shown data are just a statistical size, which is not forced to be the realistic data of every LED.



The light source of this luminaire may only be replaced by the manufacturer or by a service technician appointed by him or by a comparable qualified person

Product datasheet

Article no.: 740006

Underwater lamp, Fiara, silver, 24V DC, 18,50 W, warmwhite

Technical Data

General Characteristics

Material	stainless steel
Colour	silver
Optics	
included in delivery	10,0m connection cable with WEIPU connector IP67 1x hexagon socket wrench



Electrical Characteristics

Power / power consumption	18,50 W / 18,50 W
Input voltage	24V DC
Input current	
Base (standard designation)	
Number of bases	
Power supply unit	excl. LED-power supply unit
Connection possibility	Weipu Male
Protection class I, II, III	III

Light Technical Data

Bulb	LED-module fixed
Colour Designation	warmwhite
Colour temperature	3000 K
Luminous flux	1200 lm
Beam angle	22°
LED type	COB
LED quantity	1
Spectral power distribution	582 nm

Product datasheet

Article no.: 740006

Underwater lamp, Fiara, silver, 24V DC, 18,50 W, warmwhite

Light Direction

Rotating and tilting range	rotatable-swivel
Angle of inclination	180°
Radiation direction	
Reflector / lense	symmetrisch

Dimensions & Weight

Length	127 mm
Width	120 mm
Height	195 mm
Diameter	127 mm
Mounting Depth	
Product Weight	2313 g

Cut-out dimensions

Length	
Width	
Diameter	

Mounting Bowl

Material	
Length	
Width	
Height	
Diameter	

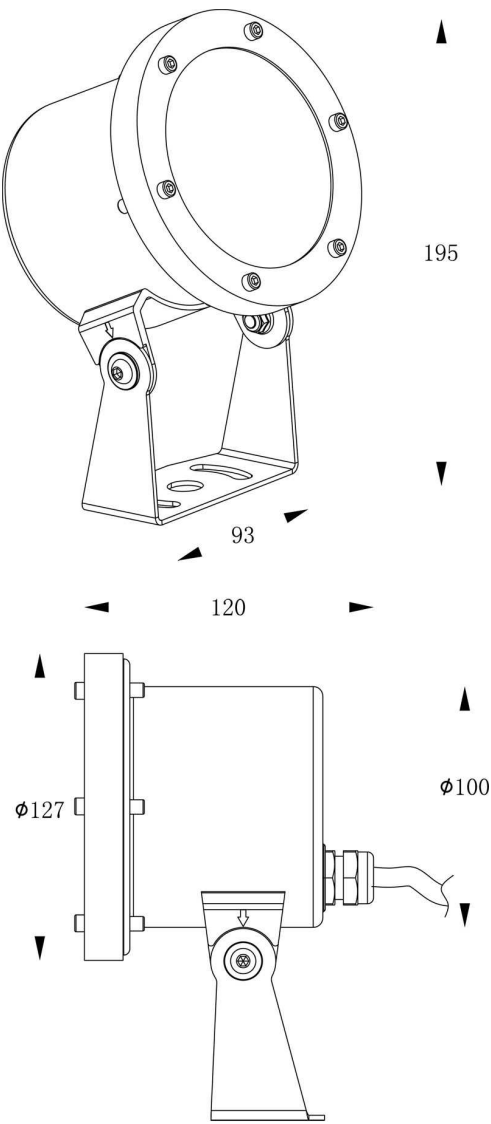

Product datasheet

Article no.: 740006

Underwater lamp, Fiara, silver, 24V DC, 18,50 W, warmwhite

Absolute maximum ratings

The LED will get damaged and the lifetime will decrease when you overrun absolute maximum ratings.

Working temperature	-20°C - +50°C
Storage temperature	-20°C - +60°C
IP - Code	IP68/max.2m

General product data

Environmental Characteristics

Energy label	A
Energy consumption	17 kWh/1000h

Lifespan

Lamp life time	25000 h
Luminous flux (end of lifetime)	0,70
Number of switching cycles	100000

IP68/max.2m Protection against penetration of dust. (complete dust protection) Protection against permanently immersion (max. 2m). IP rating refers only to the light.



Lightings of Protection Class III
Luminaire in which protection against electric shock relies on supply at safety extra-low voltage (SELV) and in which voltages higher than those of SELV are not generated.



Because of the complex manufacturing process of the LED the above shown data are just a statistical size, which is not forced to be the realistic data of every LED.



The light source of this luminaire may only be replaced by the manufacturer or by a service technician appointed by him or by a comparable qualified person