

Product datasheet

Surface mounted wall lamp, Alkes S, dark gray, 220-240V AC/50-60Hz, warmwhite

Technical Data

General Characteristics

Material	aluminum die casting / glass
Colour	dark gray
Optics	
included in delivery	2x mounting screws 2x dowels allen key



Electrical Characteristics

Power / power consumption	/ 21,00 W
Input voltage	220-240V AC/50-60Hz
Input current	
Base (standard designation)	
Number of bases	
Power supply unit	incl. LED-power supply unit
Electronically reversible	not dimmable
Connection possibility	clamp
Protection class I, II, III	I

Light Technical Data

Bulb	LED-module fixed
Colour Designation	warmwhite
Colour temperature	3000 K
Luminous flux	920 lm
Beam angle	110°
LED type	SMD
LED quantity	48
Spectral power distribution	583 nm



Product datasheet

Surface mounted wall lamp, Alkes S, dark gray, 220-240V AC/50-60Hz, warmwhite

Light Direction

Rotating and tilting range	fixed
Angle of inclination	
Radiation direction	
Reflector / lense	

Dimensions & Weight

Length	200,00
Width	126,00
Height	184,00
Diameter	0,00
Suspensions from ceiling	0,00
Product Weight	1040 g

Base dimensions

Length	0,00
Width	0,00
Height	0,00
Diameter	0,00

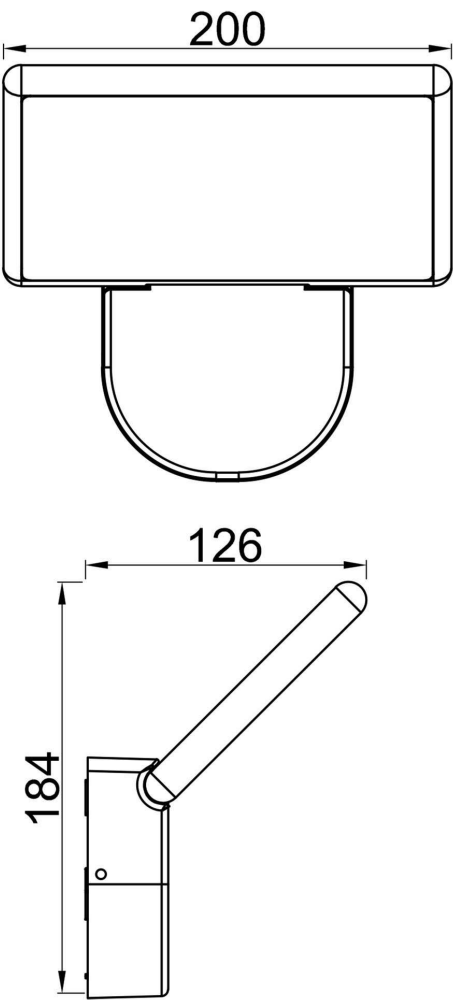

Product datasheet

Surface mounted wall lamp, Alkes S, dark gray, 220-240V AC/50-60Hz, warmwhite

Absolute maximum ratings

The LED will get damaged and the lifetime will decrease when you overrun absolute maximum ratings.

Working temperature	-20°C - +50°C
Storage temperature	-10°C - +60°C
IP - Code	IP65



General product data

Environmental Characteristics

Energy label	
Energy consumption	21 kWh/1000h

Lifespan

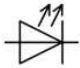
Lamp life time	26500 h
Luminous flux (end of lifetime)	0,70
Number of switching cycles	15000

IP65	Protection against penetration of dust. (complete dust protection) Protection against penetration of water jets.
	Lightings of Protection Class I in which the protection against electric shock is not based solely on isolation, but an additional safety measure contains such a way that accessible conductive parts are equipped with means for connection to the protective conductor of the fixed installation, so that in case of failure of the basic insulation exposed conductive parts cannot be active.
	Because of the complex manufacturing process of the LED the above shown data are just a statistical size, which is not forced to be the realistic data of every LED.
	The light source of this luminaire may only be replaced by the manufacturer or by a service technician appointed by him or by a comparable qualified person

Product datasheet

Surface mounted wall lamp, Alkes S Motion, dark gray, 220-240V AC/50-60Hz, warmwhite

Technical Data

General Characteristics

Material	aluminum die casting / glass
Colour	dark gray
Optics	
included in delivery	2x mounting screws, 2x dowels, screw driver



Electrical Characteristics

Power	21,00 W
Input voltage	220-240V AC/50-60Hz
Input current	
Base (standard designation)	
Number of bases	
Power supply unit	incl. LED-power supply unit
Electronically reversible	motion sensor
Connection possibility	clamp
Protection class I, II, III	I

Light Technical Data

Bulb	Lichtquelle fest
Colour Designation	warmwhite
Colour temperature	3000 K
Luminous flux	735 lm
Beam angle	110°
LED type	SMD
LED quantity	48
Spectral power distribution	6006 nm



Product datasheet

Surface mounted wall lamp, Alkes S Motion, dark gray, 220-240V AC/50-60Hz, warmwhite

Light Direction

Rotating and tilting range	fixed
Angle of inclination	120 °
Radiation direction	
Reflector / lense	

Dimensions & Weight

Length (mm)	200,00
Width (mm)	126,00
Height (mm)	184,00
Diameter (mm)	0,00
Suspensions from ceiling (mm)	0,00
Product Weight	1070 g

Base dimensions

Length (mm)	0,00
Width (mm)	0,00
Height (mm)	0,00
Diameter (mm)	0,00

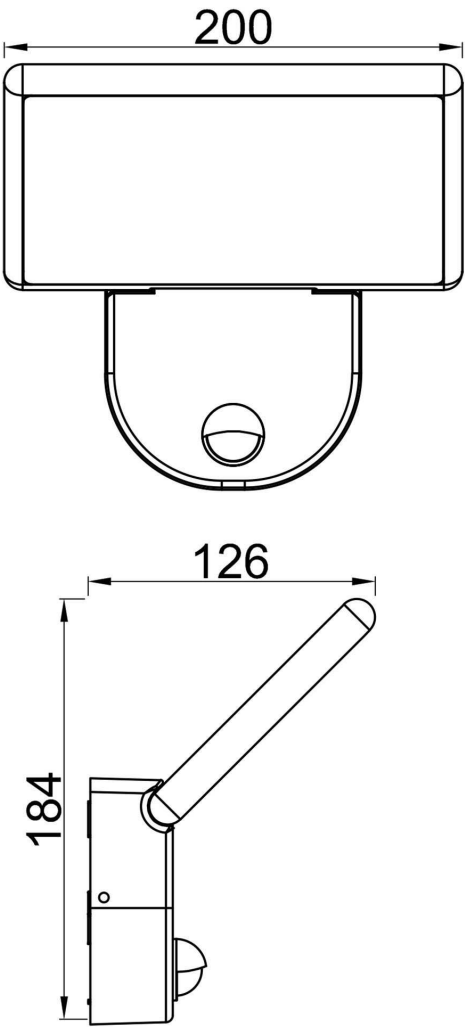

Product datasheet

Surface mounted wall lamp, Alkes S Motion, dark gray, 220-240V AC/50-60Hz, warmwhite

Absolute maximum ratings

Working temperature	-20°C - +50°C
Storage temperature	
IP - Code	IP65

General product data

Environmental Characteristics

Energy label	G
Energy consumption	21 kWh/1000h

Lifespan

Lamp life time	26500 h
Luminous flux (end of lifetime)	0,70
Number of switching cycles	13250

EEI	This product contains a light source of energy efficiency class G
IP65	Protection against penetration of dust. (complete dust protection) Protection against penetration of water jets.
	Lightings of Protection Class I in which the protection against electric shock is not based solely on isolation, but an additional safety measure contains such a way that accessible conductive parts are equipped with means for connection to the protective conductor of the fixed installation, so that in case of failure of the basic insulation exposed conductive parts cannot be active.

Product datasheet

Surface mounted wall lamp, Alkes L, dark gray, 220-240V AC/50-60Hz, warmwhite

Technical Data

General Characteristics

Material	aluminum die casting / glass
Colour	dark gray
Optics	
included in delivery	2x mounting screws 2x dowels allen key



Electrical Characteristics

Power	36,00 W
Input voltage	220-240V AC/50-60Hz
Input current	
Base (standard designation)	
Number of bases	
Power supply unit	incl. LED-power supply unit
Electronically reversible	not dimmable
Connection possibility	clamp
Protection class I, II, III	I

Light Technical Data

Bulb	Lichtquelle fest
Colour Designation	warmwhite
Colour temperature	3000 K
Luminous flux	1720 lm
Beam angle	110°
LED type	SMD
LED quantity	96
Spectral power distribution	583 nm



Product datasheet

Surface mounted wall lamp, Alkes L, dark gray, 220-240V AC/50-60Hz, warmwhite

Light Direction

Rotating and tilting range	fixed
Angle of inclination	
Radiation direction	
Reflector / lense	

Dimensions & Weight

Length (mm)	297,00
Width (mm)	165,00
Height (mm)	240,00
Diameter (mm)	0,00
Suspensions from ceiling (mm)	0,00
Product Weight	1905 g

Base dimensions

Length (mm)	0,00
Width (mm)	0,00
Height (mm)	0,00
Diameter (mm)	0,00

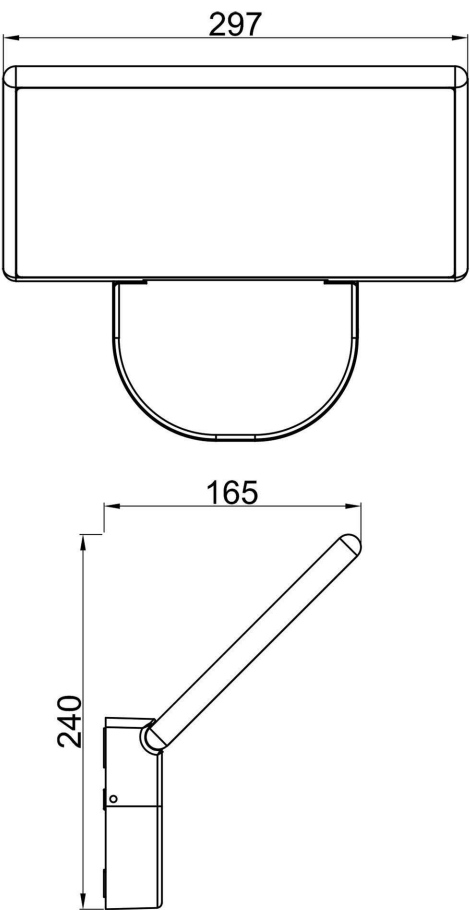

Product datasheet

Surface mounted wall lamp, Alkes L, dark gray, 220-240V AC/50-60Hz, warmwhite

Absolute maximum ratings

Working temperature	-20°C - +50°C
Storage temperature	-10°C - +60°C
IP - Code	IP65

General product data

Environmental Characteristics

Energy label	G
Energy consumption	36 kWh/1000h

Lifespan

Lamp life time	26500 h
Luminous flux (end of lifetime)	0,70
Number of switching cycles	15000

EEI	This product contains a light source of energy efficiency class G
IP65	Protection against penetration of dust. (complete dust protection) Protection against penetration of water jets.
	Lightings of Protection Class I in which the protection against electric shock is not based solely on isolation, but an additional safety measure contains such a way that accessible conductive parts are equipped with means for connection to the protective conductor of the fixed installation, so that in case of failure of the basic insulation exposed conductive parts cannot be active.

Product datasheet

Surface mounted wall lamp, Alkes L Motion, dark gray, 220-240V AC/50-60Hz, warmwhite

Technical Data

General Characteristics

Material	aluminum die casting / glass
Colour	dark gray
Optics	
included in delivery	2x mounting screws 2x dowels allen key



Electrical Characteristics

Power	36,00 W
Input voltage	220-240V AC/50-60Hz
Input current	
Base (standard designation)	
Number of bases	
Power supply unit	incl. LED-power supply unit
Electronically reversible	motion sensor
Connection possibility	clamp
Protection class I, II, III	I

Light Technical Data

Bulb	Lichtquelle fest
Colour Designation	warmwhite
Colour temperature	3000 K
Luminous flux	1720 lm
Beam angle	110°
LED type	SMD
LED quantity	96
Spectral power distribution	604,5 nm



Product datasheet

Surface mounted wall lamp, Alkes L Motion, dark gray, 220-240V AC/50-60Hz, warmwhite

Light Direction

Rotating and tilting range	fixed
Angle of inclination	
Radiation direction	
Reflector / lense	

Dimensions & Weight

Length (mm)	297,00
Width (mm)	165,00
Height (mm)	240,00
Diameter (mm)	0,00
Suspensions from ceiling (mm)	0,00
Product Weight	1935 g

Base dimensions

Length (mm)	0,00
Width (mm)	0,00
Height (mm)	0,00
Diameter (mm)	0,00

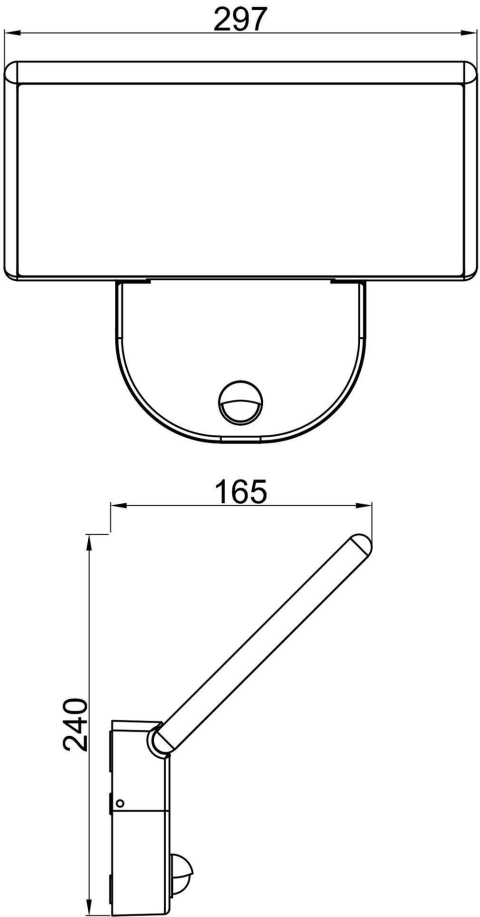

Product datasheet

Surface mounted wall lamp, Alkes L Motion, dark gray, 220-240V AC/50-60Hz, warmwhite

Absolute maximum ratings

Working temperature	-20°C - +50°C
Storage temperature	-10°C - +60°C
IP - Code	IP65

General product data

Environmental Characteristics

Energy label	G
Energy consumption	36 kWh/1000h

Lifespan

Lamp life time	26500 h
Luminous flux (end of lifetime)	0,70
Number of switching cycles	15000

EEI	This product contains a light source of energy efficiency class G
IP65	Protection against penetration of dust. (complete dust protection) Protection against penetration of water jets.
	Lightings of Protection Class I in which the protection against electric shock is not based solely on isolation, but an additional safety measure contains such a way that accessible conductive parts are equipped with means for connection to the protective conductor of the fixed installation, so that in case of failure of the basic insulation exposed conductive parts cannot be active.